

Newsletter

13.2022

KFGN35 overrun coupling devices

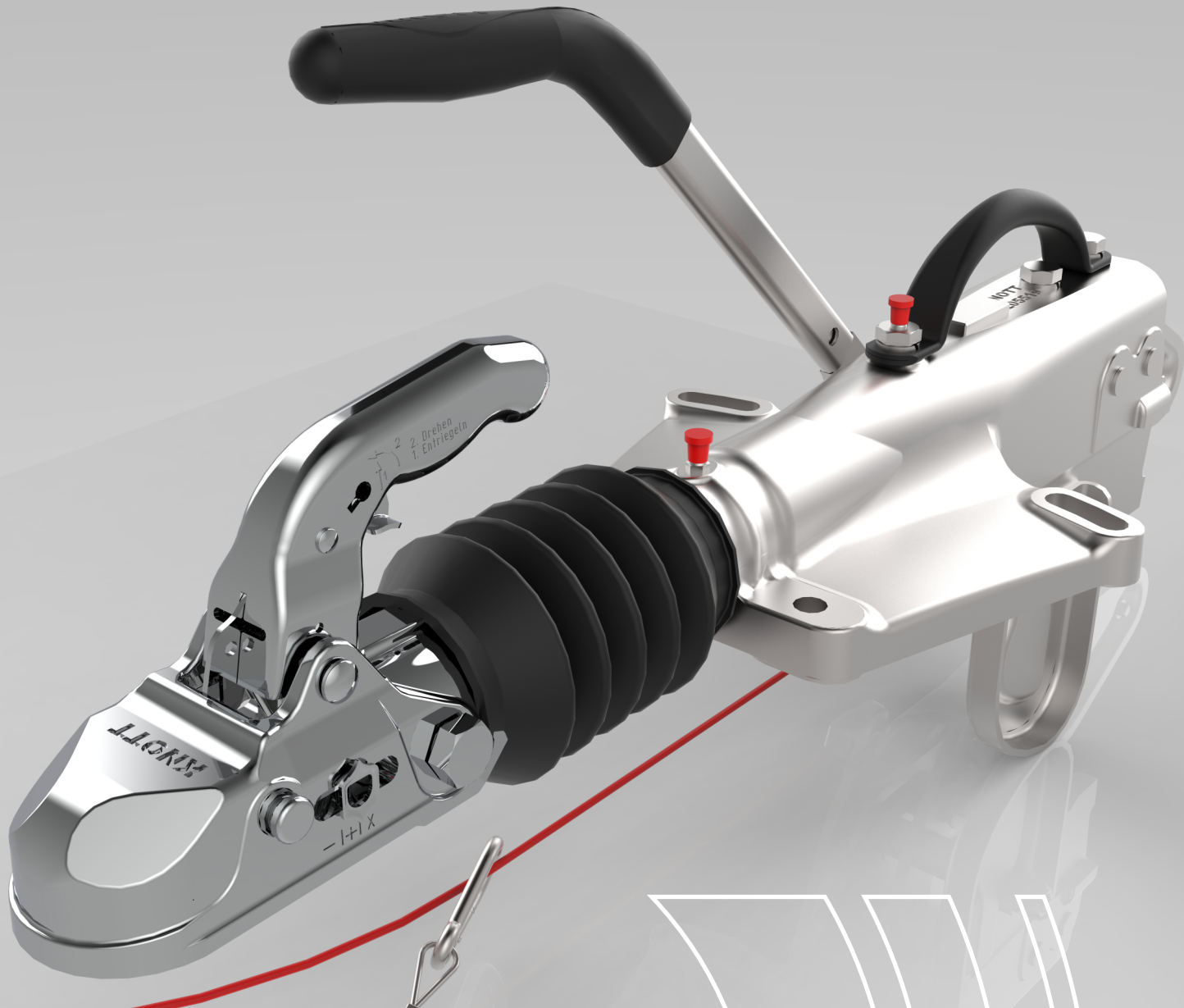

knott.pl

Dear Sirs,

We would like to introduce you to the alternative of the KFG35 GF overrun device. The offered KFGN35 device is attached to the drawbar with 4 M14 bolts, thanks to which it is possible to use a smaller device housing.

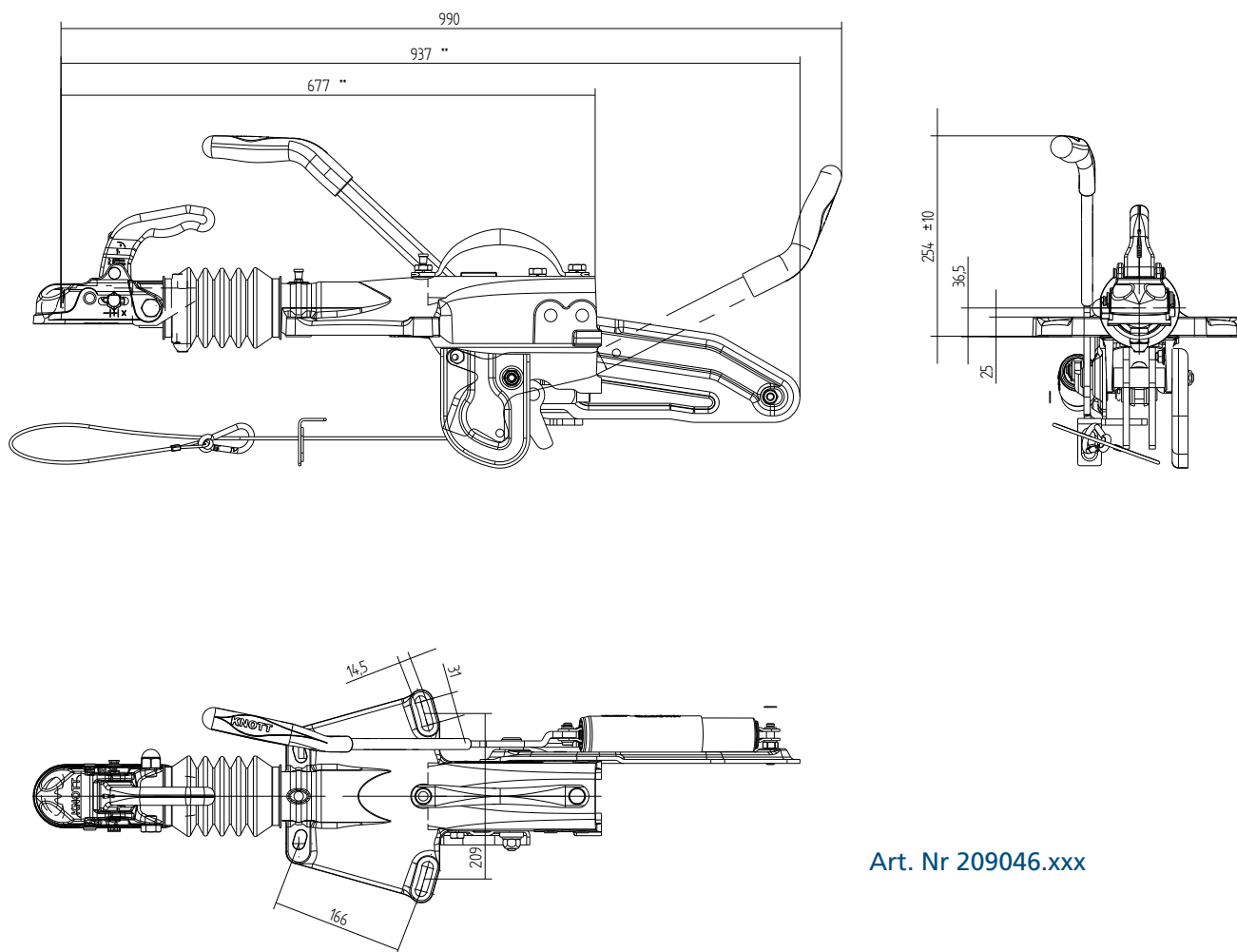

Art. Nr 209046.xxx

The KFGN35 device is available in a mechanical version - type A and in a hydraulic version - versions B, B1 and B2.

The operating range of the device is 2000-3500 kg, with a permissible vertical pressure of 250 kg for each of the available and offered versions. If you have this type of overrun device in your full truckload approval, you can use it interchangeably with overrun devices up to 3500 kg of our company, but also with competitors.

The approval number of the offered device is:

E1*55R01/00*2758*00 (designation **E1 55R-01 2758**).

Below is a summary of the differences between the KFG30-A, KFGN35-A and KFG35-D overrun devices

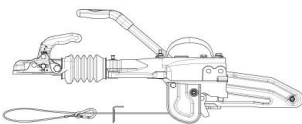
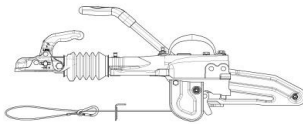
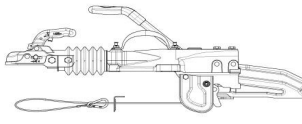
	KFG30-A	KFGN35-A	KFG35-D
	Art. Nr 202350.004	Art. Nr 209046.001	203090.001
			
The mass of the device	24,5 kg	24,8 kg	29,5 kg
Work range	1600-3000 kg	2000-3500 kg	2700-3500 kg
Maximum pressure vertical - S	300 kg	250 kg	350 kg
Shock absorber Art. Nr	87003913	87004813	87003613
Piston rod compl. Art. Nr	98857593 DIA50x10	209068.001 DIA50x10	203146.001 DIA60x8
Attaching the coupling	M14/M12 na krzyż	M14/M14 na krzyż	M14/M14 poziomo
Fixing the device to the drawbar	4xM12 - 10.9 4xM14 - 8.8 4xM14 - 10.9	4xM14 - 8.8 4xM14 - 10.9	6xM12 - 10.9 4xM14 - 8.8 4xM14 - 10.9

The above list shows that the device can be an ideal replacement for devices such as KFG30-A and KFG35-D. The operating range of all devices is similar, and the undoubted advantage of this solution is the reduction of the chassis weight for the tonnage up to 3500 kg by 4.5 kg, which increases the permissible load capacity of the trailer while maintaining the same parameters.

The device can be used for any type of trailer, from transport trailers, through boat trailers, box trailers, excavators for transporting excavators, as well as caravans and horse trailers.

Exemplary use of the device in trailer chassis:

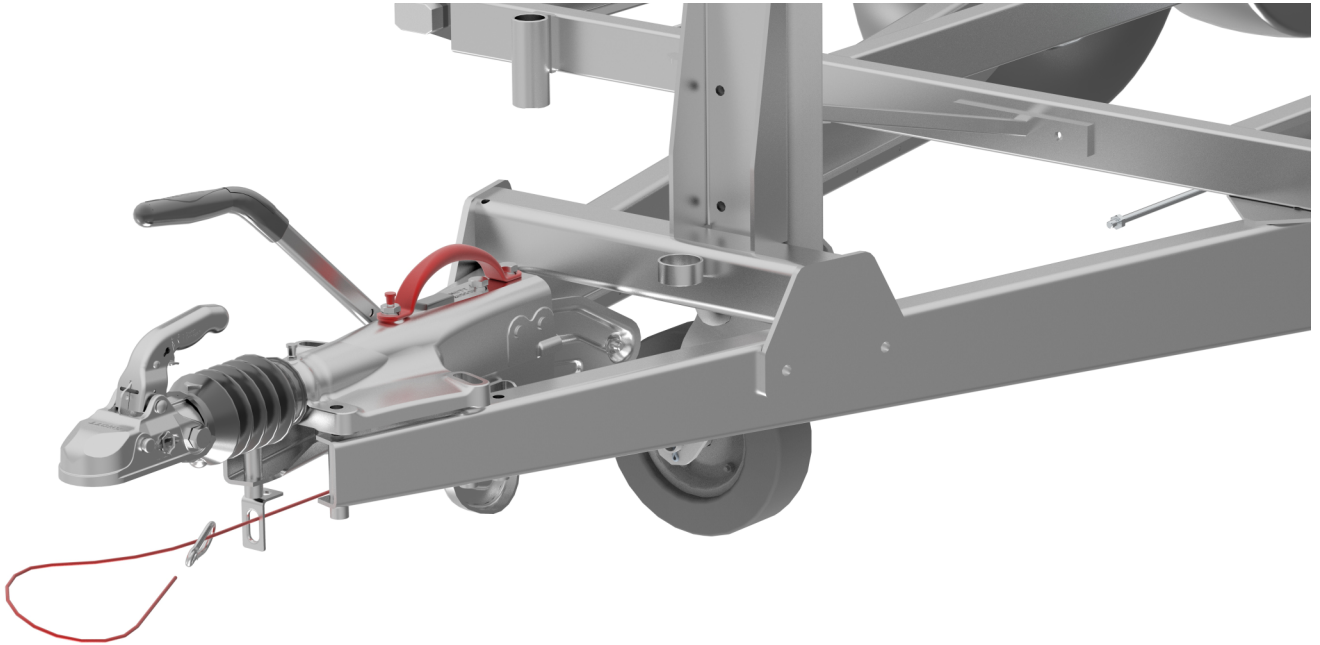

The overrun device can be freely used in all types of trailers, regardless of whether it is a catering trailer, boat trailer or horse transport.



The device is compatible with a screwed console, so you can freely use versions with or without the console.



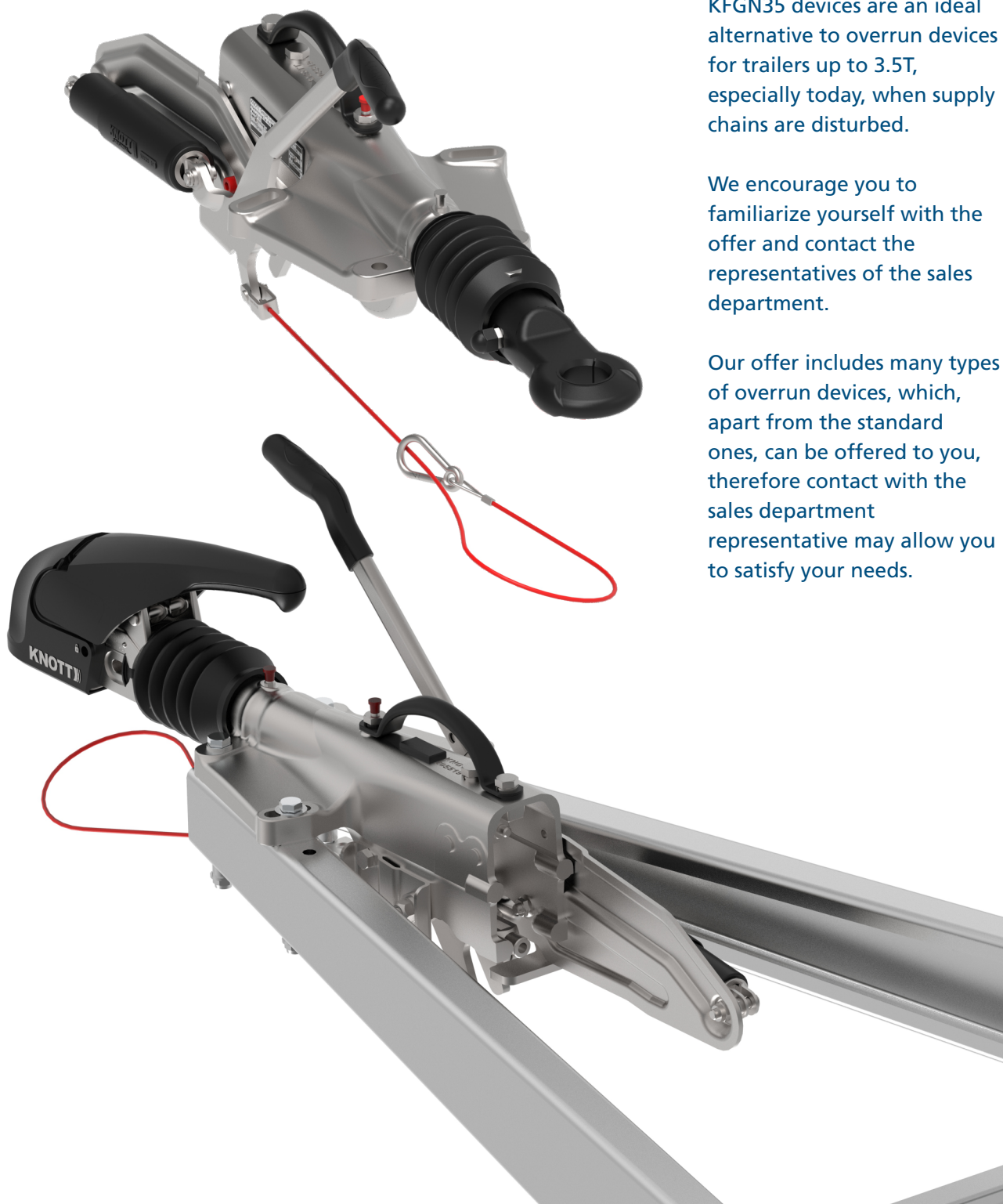

KFGN35 devices are an ideal alternative to overrun devices for trailers up to 3.5T, especially today, when supply chains are disturbed.

We encourage you to familiarize yourself with the offer and contact the representatives of the sales department.

Our offer includes many types of overrun devices, which, apart from the standard ones, can be offered to you, therefore contact with the sales department representative may allow you to satisfy your needs.

Detailed information about the products is provided by the Trade Department of KNOTT Sp. z o.o.

KNOTT Sp. z o.o.

63-011 Pławce
Zdziechowice 100
tel. 61 287 60 00
fax 61 287 60 01
info@knott.pl
www.knott.pl

