

# Newsletter

05.2023

Couplings K7,5 N4

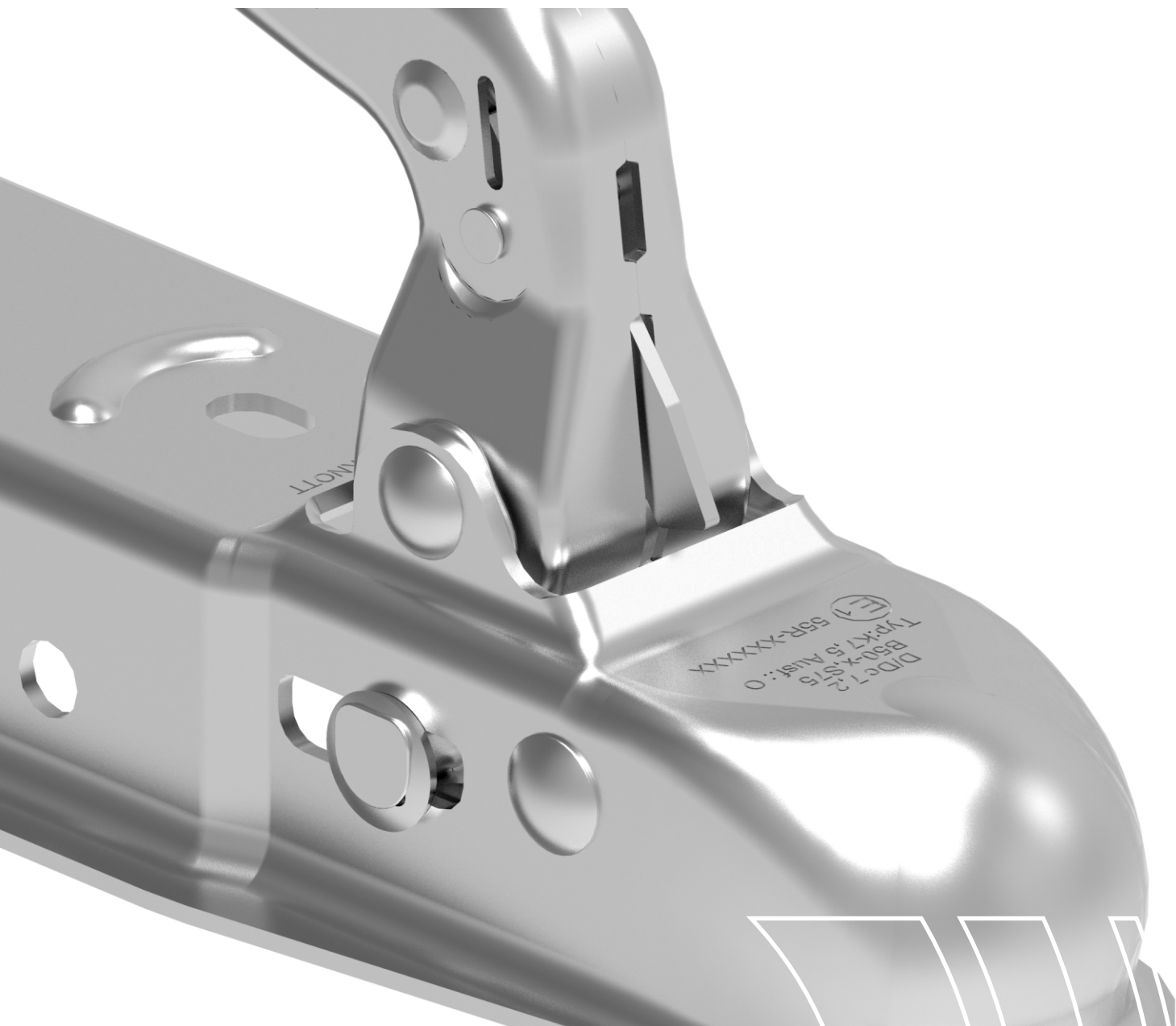

knott.pl



Dear Sirs,

we present to you K7.5 ball couplings with a new version of the handle. The latest solution is characterized by high quality workmanship, which, combined with aesthetics, gives you a product of the highest quality.

The range of K7.5 couplings is large due to the variety of applications and connections, but each of them is equipped with a lever with the N4 designation. Below we present the catches in a new version, depending on the connection size to the profile.



Art. No 6E0534.001

Each version of the coupling is equipped with a new lever, thanks to which it is very easy to open or close the latch. The lever is handy and refers to the most popular hooks in our group.



Art. No 6E0534.008

The angular range of the couplings operation and their values of vertical pressure and strength have not changed. They are 100% compatible with other hitches from Knott, but also with couplings from other manufacturers available on the market of trailer components.

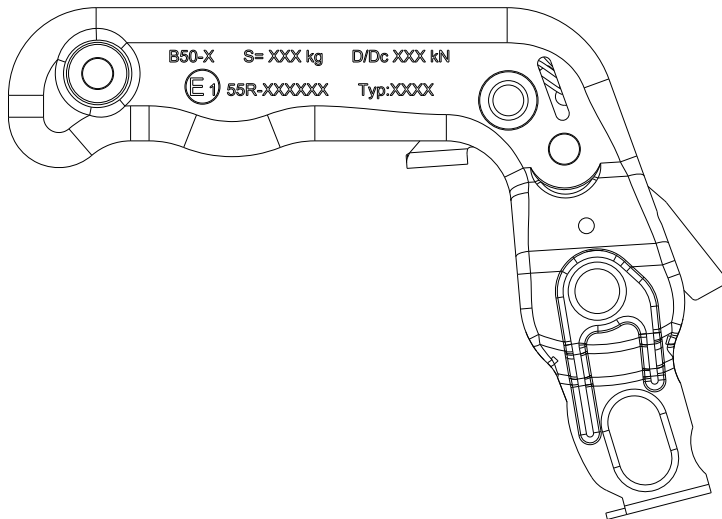

The main difference in the presented coupling is the N4 type handle. The new solution in the K7.5 coupling is known from other hooks offered by Knott.

The main advantage is the compact and construction, and thanks to the appropriate embossing also high stiffness.

The offered handle is profiled under the hand, thanks to which it grips securely and the ball catch can be opened very easily.



Art. No 6E0534.xxx

Due to the fact that it is made of two pressed metal sheets, the handle retains very high rigidity.

The connection is made with a rivet, thanks to which we gain even higher corrosion resistance because we minimize the possibility of damage to the zinc coating during welding or screwing of elements.



Art. No 205930.xxx



Art. No 6E0534.005

The coupling is adapted for quick assembly of the plug holder - made of a properly bent wire.

Of course, we offer versions with a factory-fitted plug holder, but the catch can be retrofitted at any stage of the product's life.



Art. No P3900010xx

The catches also have a hole for mounting a security lock. Once the lock is fixed in the hitch lever, it is impossible to open the hitch and release it from the ball of the towing vehicle's hook.

This solution significantly increases the safety of your trailer, preventing third parties from stealing.

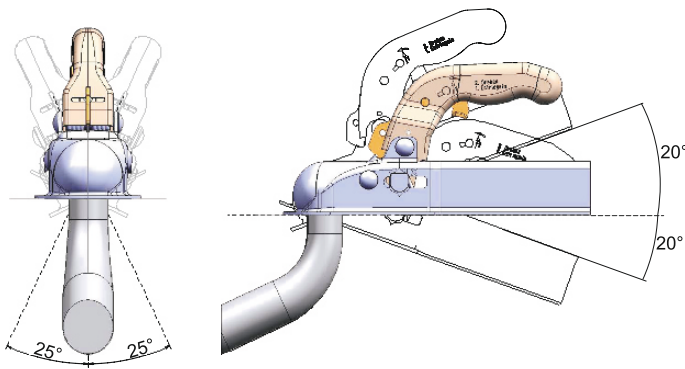

The range of operation of the coupling is standard, as for the other couplings in our offer.

The range of strength values and vertical pressure on the ball also remains unchanged:

**D/Dc = 7,2 kN**

**S = 75 kg**

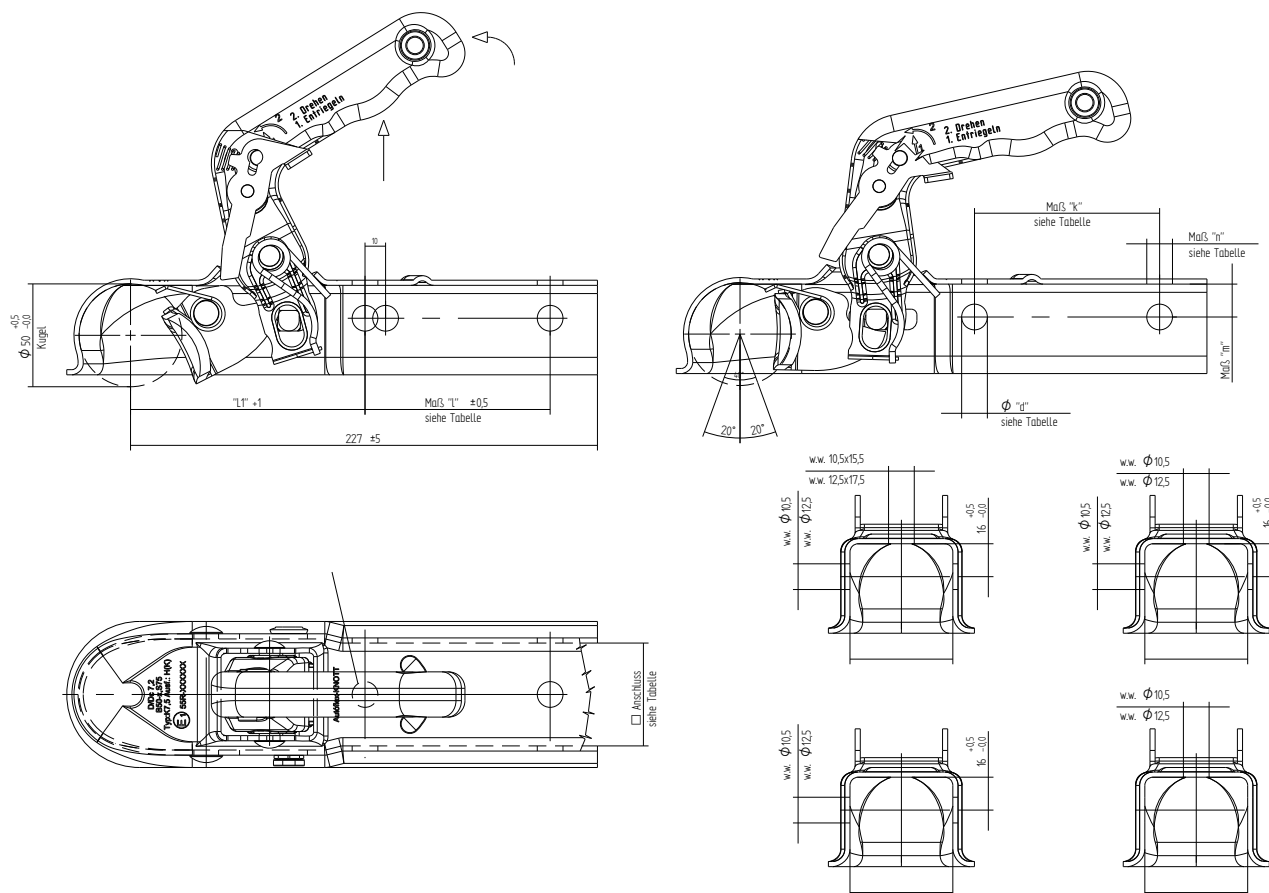

6E0544.010	F	□ 40	90	Ø12,5	16			without
6E0544.009	S	□ 40				90	Ø12,5	without
6E0544.008	M	□ 70				90	Ø12,5	without
6E0544.007	I (L)	□ 60	90	Ø12,5	16	90	Ø12,5	without
6E0544.006	L	□ 60				90	Ø12,5	without
6E0544.005	O	□ 60	80	Ø10,5	25	85	10,5x15,5	without
6E0544.004	K	□ 50				90	Ø12,5	6E5098.001
6E0544.003	N	□ 50	80	Ø10,5	25	85	10,5x15,5	without
6E0544.002	N	□ 50	90	Ø12,5	25	85	12,5x17,5	without
6E0544.001	H (K)	□ 50	90	Ø12,5	16	90	Ø12,5	without
Art. No	version	connection dimension	dimension l	Ø "d"	dimension m	dimension k	dimension n	Plug holder
								Art. N0

Detailed information about the products is provided by the KNOTT Sp. z o. o.

**KNOTT**

KNOTT Sp. z o.o.

63-011 Pławce  
Zdziechowice 100  
tel. 61 287 60 00  
fax 61 287 60 01  
info@knott.pl  
[www.knott.pl](http://www.knott.pl)

